

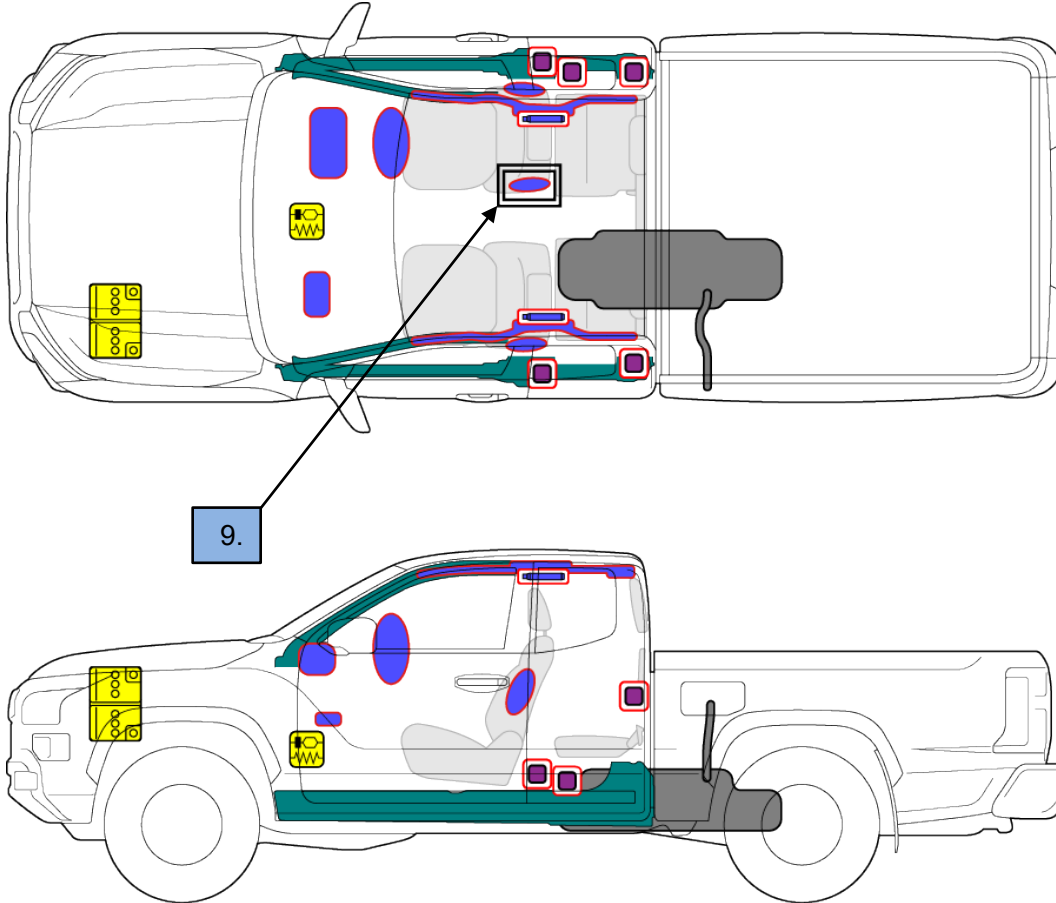

MITSUBISHI TRITON
4 doors / 4 seats / Club Cab
(2024 -)



UTCC0002EAMK

	Airbag		Stored gas inflator		Seat belt Pretensioner		SRS control unit		High strength Zone
	Zone requiring special attention		Battery low voltage		Fuel tank		Fuel tank content Diesel		
ID No.					Version No.	Version Date.	Page		
LBLCTCC-ANRS-EN01					01	11/2023	1/4		

1. Identification / recognition

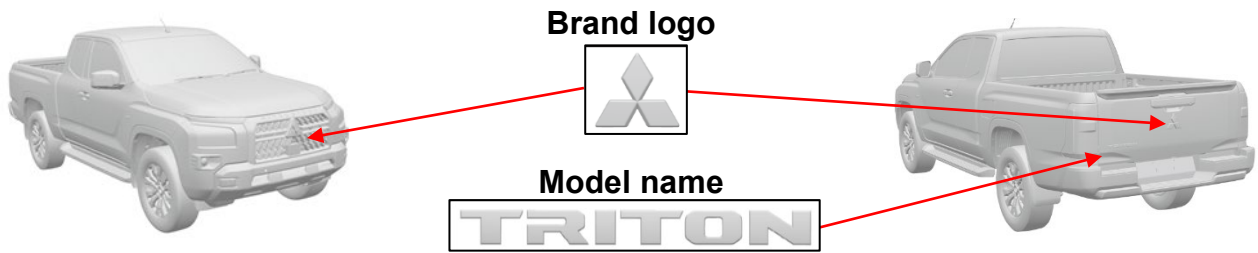

2. Immobilisation / stabilization / lifting

Immobilise the vehicle:

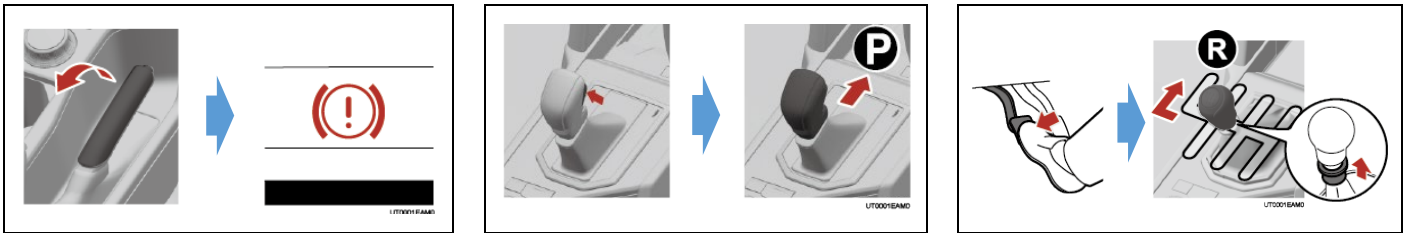

1. Block the wheels.
2. Set the parking brake.

3. Automatic transmission:
Move the selector to the "P" position.

3. Manual transmission:
Move the gearshift to the "R" position.

Lifting points:

Front jacking points

Rear jacking points

- Appropriate stabilisation-lifting points
- Support positions for garage jacks

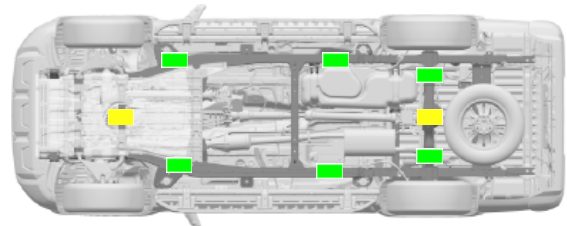
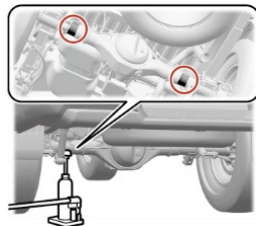
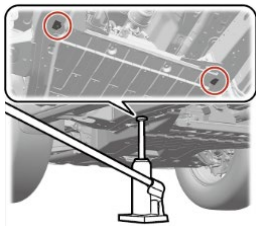

3. Disable direct hazards / safety regulations

Main disabling method:

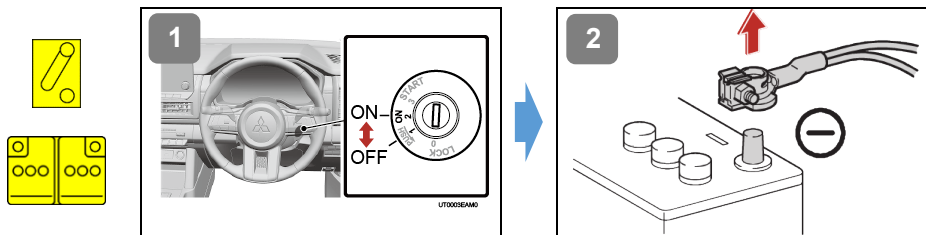

Access:

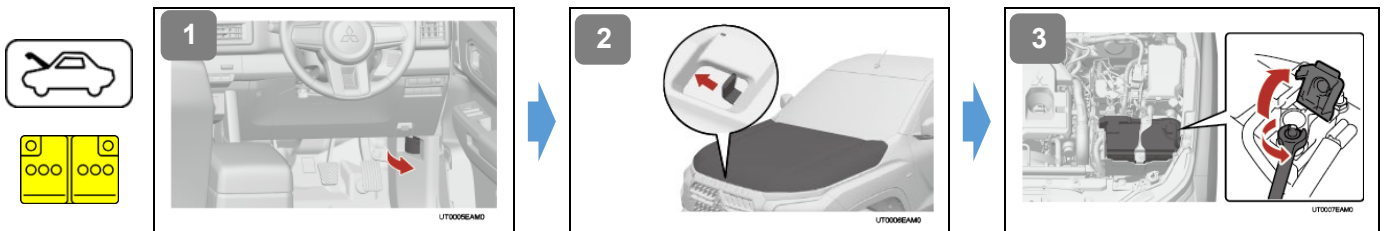

	ID No.	Version No.	Version Date.	Page
	LBLCTCC-ANRS-EN01	01	11/2023	2/4

4. Access to the occupants

Glass types:

A: Laminated glass

B: Tempered glass

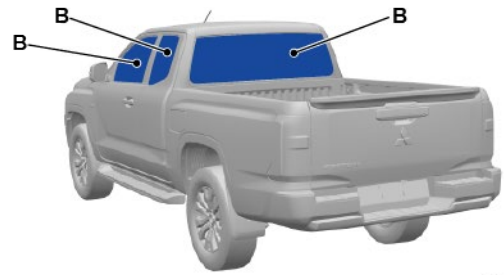
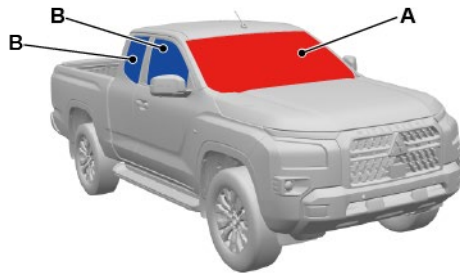

UTC0006EAM0

Seat adjustment:



Recline the seatback



Steering column adjustment:

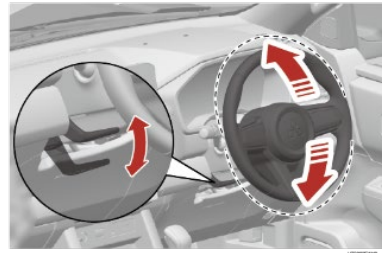

Telescopic mechanism

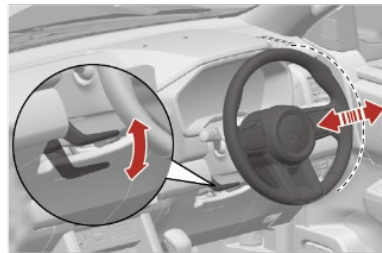

High strength steel in body:

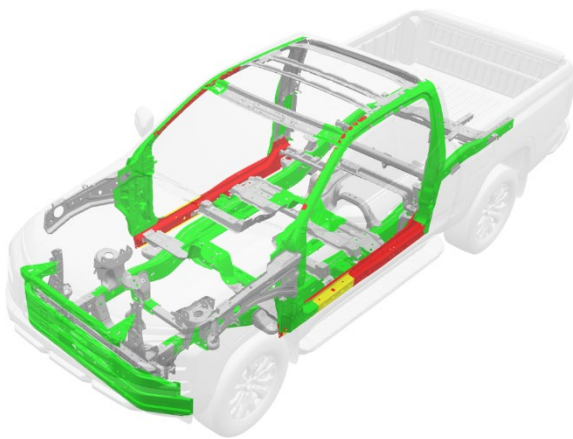

- 440 MPa
- 590 MPa
- 980 MPa
- 1180 MPa

UTC0006EAM0

5. Stored energy / liquids / gases / solids

		12 V
		HFC-134a: 530–570 g HFO-1234yf [R-1234yf]: 530–570 g
		75 L

	ID No.	Version No.	Version Date.	Page
	LBLCTCC-ANRS-EN01	01	11/2023	3/4

6. In case of fire



Use large amount of water



7. In case of submersion



Work on the vehicle only after the vehicle has been pulled out of the water.

8. Towing / transportation / storage

Store at safe distance from other vehicles!

2WD

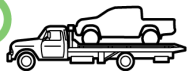

LIT0014EAM0

4WD

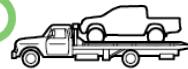

LIT0015EAM0

9. Important additional information

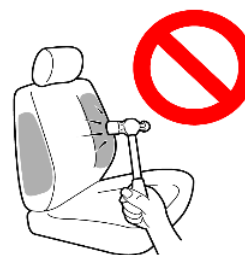
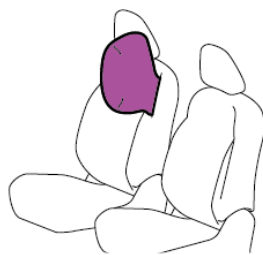

Driver's seat has a centre airbag in addition to the side airbag. Location of centre airbag is shown in the mark **9** on page 1.



Do not apply excessive force to nor strongly hit the airbag installation area.

10. Explanation of pictograms used

	General warning sign		Corrosives		Steering wheel, tilt control
	Warning; low temperature		Use water to extinguish the fire		Device to shut down power in vehicle
	Flammable		Air-conditioning component		Vehicle on fuel of liquid group 1
	Hazardous to the human health		Bonnet		Right hand drive
	Acute toxicity		Seat adjustment, longitudinal		
	Explosive		Seat height adjustment		

ID No.	Version No.	Version Date.	Page
LBLCTCC-ANRS-EN01	01	11/2023	4/4