

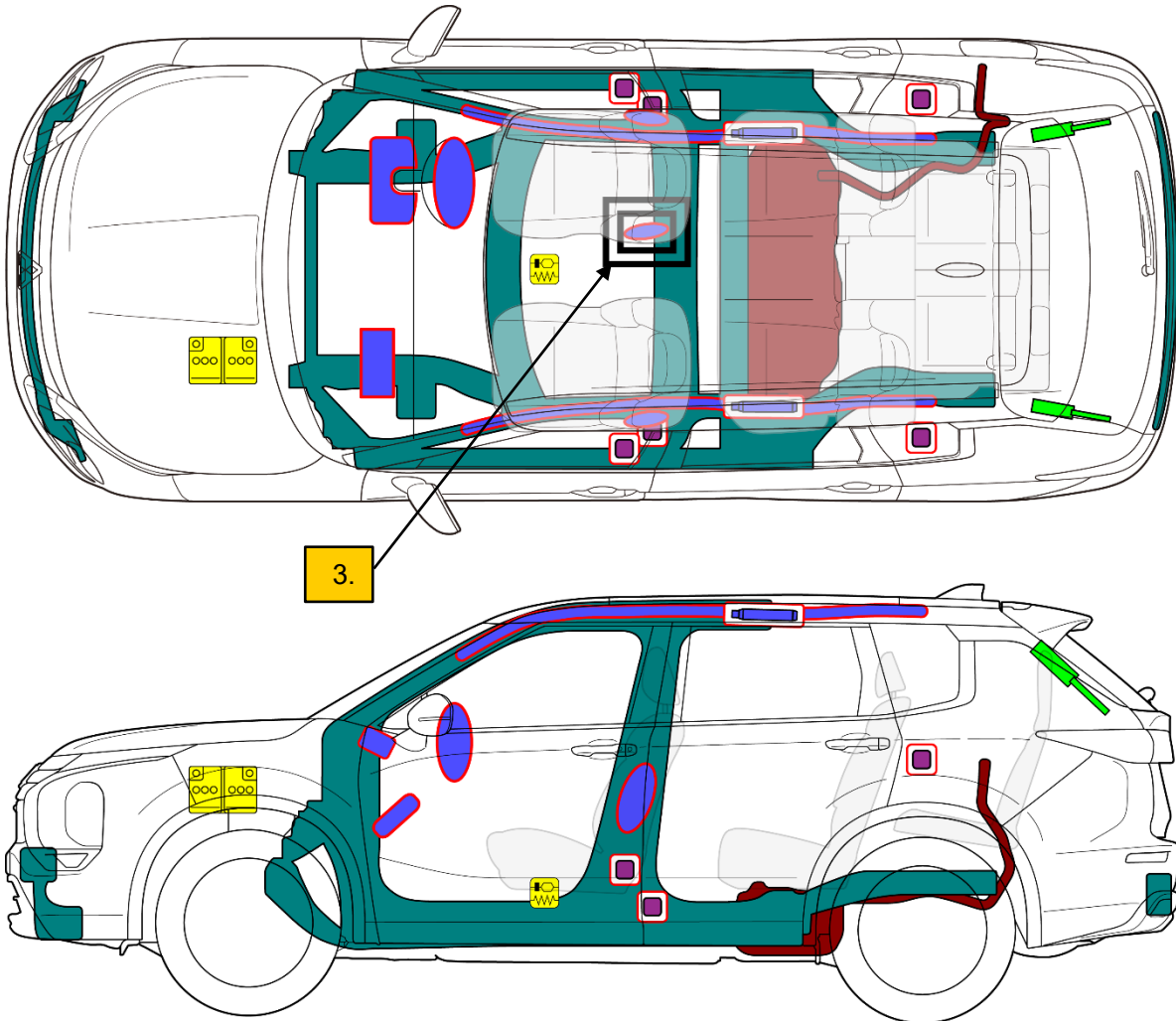

OUTLANDER

Body type: Station wagon
Type: GM4W Model year: 2021



	Airbag		Stored gas inflator		Seat belt Pretensioner		SRS control unit		Pedestrian protection active system
	Automatic rollover protection system		Gas strut / Preloaded spring		High strength Zone		Zone requiring special attention		
	Battery low voltage		Ultra capacitor, low voltage		Fuel tank		Gas tank		Safety valve
	High voltage battery pack		High voltage power cable / component		High voltage disconnect		Fuse box disabling high voltage system		Ultra capacitor, high voltage
					ID No.	Version No.	Version Date.	Page	
					GMW-ANRS-EN01	03	1/2022	1/4	



OUTLANDER

Body type: Station wagon
Type: GM4W Model year: 2021



1. Identification / recognition

Features on vehicle exterior

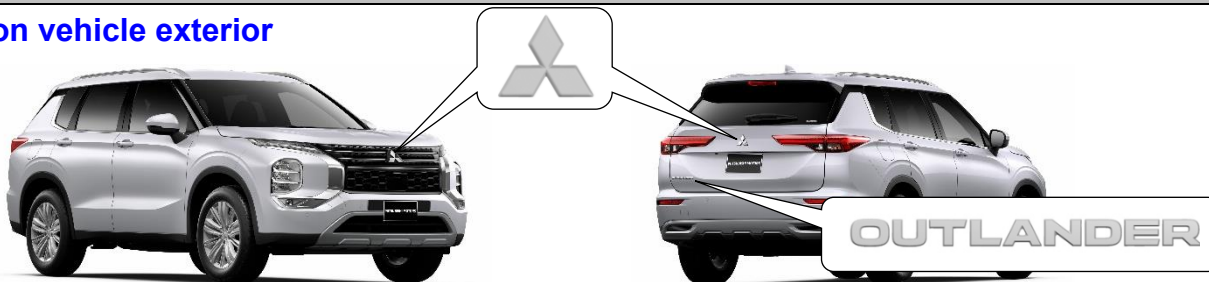

2. Immobilisation / stabilization / lifting

Immobilize the vehicle

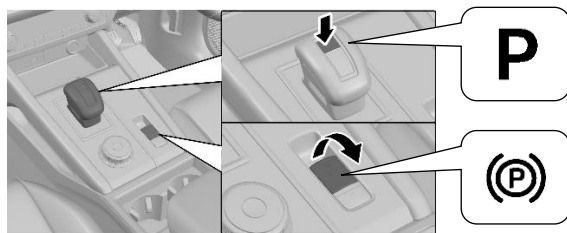

Block the wheels and set the parking brake.
Put the car in "P" position.

Support positions for Jack and Lift

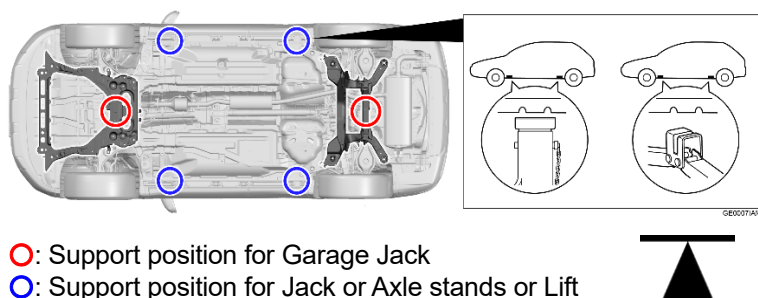

○: Support position for Garage Jack
○: Support position for Jack or Axle stands or Lift

3. Disable direct hazards / safety regulations

How to determine if vehicle is ON / OFF

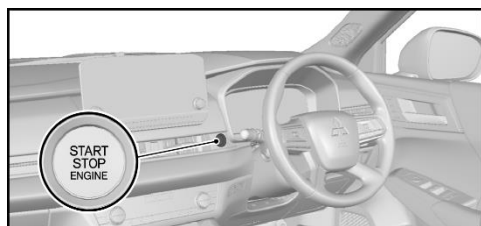

OFF

Check that the illumination of the "combination meter" is off.

ON

When the power switch is "ON", "combination meter" light up.



How to disconnect the 12V battery negative terminal

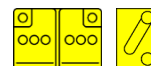
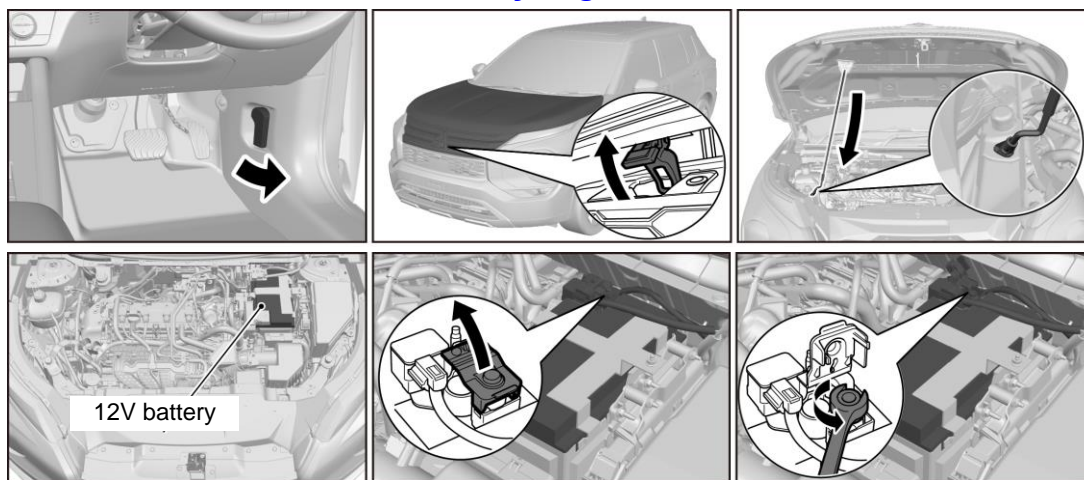

Do not apply excessive force to not strongly hit the airbag installation area.



Driver's seat has a Front seat-mounted SRS centre airbag in addition to the side airbag.

Location of far side airbag is shown in the mark **3** on page 1.

	ID No.	Version No.	Version Date.	Page
	GMW-ANRS-EN01	03	1/2022	2/4



OUTLANDER

Body type: Station wagon
Type: GM4W Model year: 2021



4. Access to the occupants

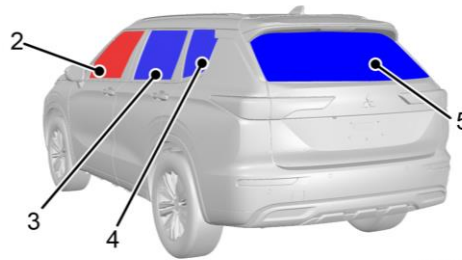
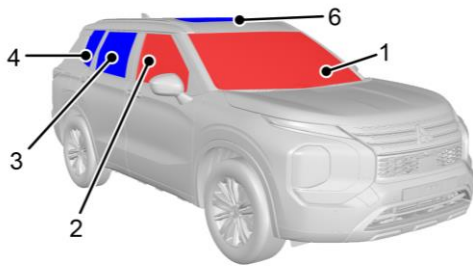

1 – 2 : Laminated glass
3 – 6 : Tempered glass

GE0017IAM0

Steering adjustment

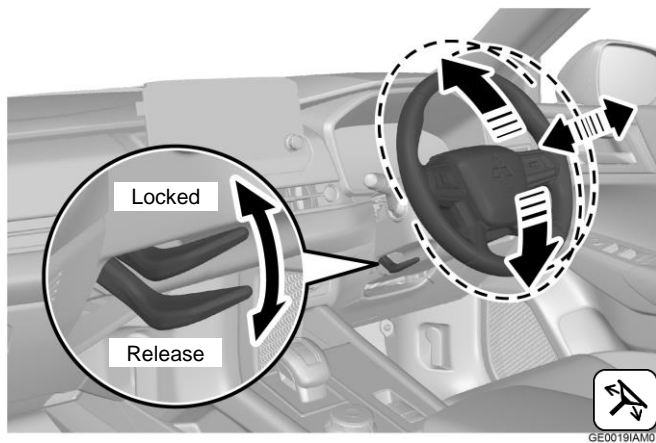

GE0019IAM0

Seat adjustment

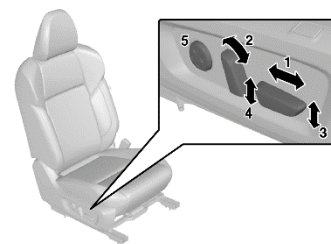

Power Seat

- 1 : Forward or backward
- 2 : Recline the seatback
- 3 : Seat tilt
- 4 : Seat height
- 5 : Lumbar support



Manual Seat

- 1 : Forward or backward
- 2 : Recline the seatback
- 3 : Seat height (driver's side only)

High-tensile and Ultra-high-tensile steel panels location

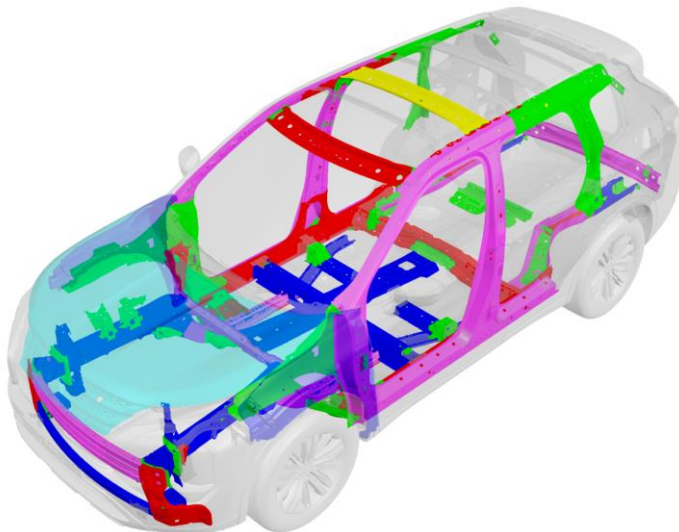

: - 440MPa	:590MPa
:780MPa	:980MPa
:1180MPa	:1470MPa
:Plastic *Used in the Front fender	:Aluminum *Used in the Hood

5. Stored energy / liquids / gases / solids

Fluids / gases used in this vehicle

	Fuel tank	55 liters		Refrigerant (air conditioner)	HFC-134a: 480 – 520g
	12V Battery	L3-EFB 70 Ah		Hood	Aluminum



	ID No.	Version No.	Version Date.	Page
	GMW-ANRS-EN01	03	1/2022	3/4



OUTLANDER

Body type: Station wagon
Type: GM4W Model year: 2021



6. In case of fire

1. Vehicle fire

In case of vehicle fire, alert fire department immediately and start extinguishing the fire using the following procedures where possible.



2. Fire-extinguishing



Use ABC powder or large quantity water to extinguish the fire

7. In case of submersion

Submerged Vehicle

- If the vehicle is submerged or partially submerged, first pull the occupants out of the vehicle and water.

8. Towing / transportation / storage

How to Transport



Store the vehicle at a safe distance from other vehicles.

9. Important additional information

Supplemental Restraint System (SRS) Location

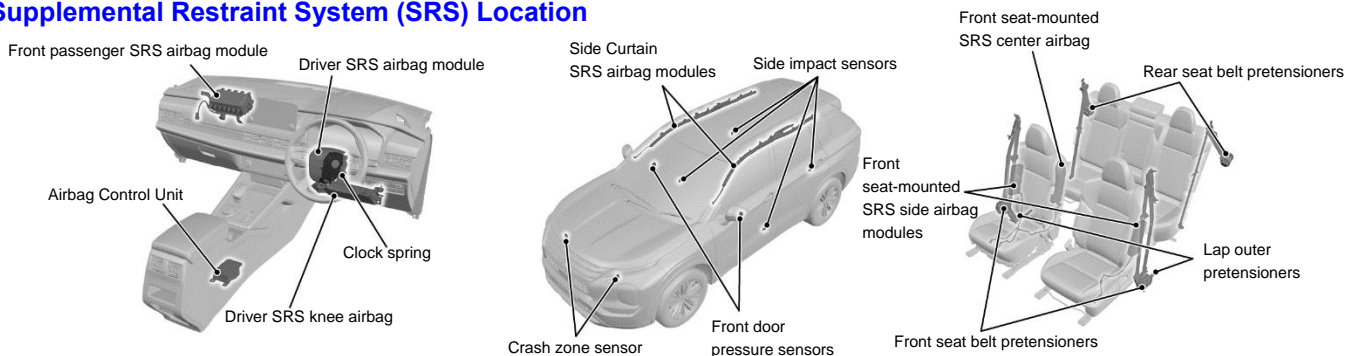

10. Explanation of pictograms used

	Keyless operation key distance		Device to shut down power in vehicle		Risk of damaging human health
	Caution		Warning, low temperature		Risk of flammability
	Open Hood		Air-conditioning component		Risk of an explosion
	Fuel tank		Use ABC powder to extinguish the fire		Risk of corrosive material / substances
	Seat height adjustment		Use water to extinguish the fire		Risk of acute toxicity
	Seat adjustment, longitudinal		Steering wheel, tilt control		Right hand drive
		ID No.	Version No.	Version Date.	Page
		GMW-ANRS-EN01	03	1/2022	4/4